



## PP fittings for polyethylene

# Adaptor with brass female threaded insert ITEM 991



REFERENCE	DESCRIPTION	Net weight	Volumen (m <sup>3</sup> )	Gross weight	Unidades lote
1012682		0,2458	0,00891	1,4164	5
1012683		0,354	0,00891	1,9574	5
1012684		0,5565	0,00891	2,9699	5
1012685		0,9479	0,00891	2,0832	2
1012686		1,7031	0,01553	3,7329	2
1012687		2,4508	0,02243	5,3893	2

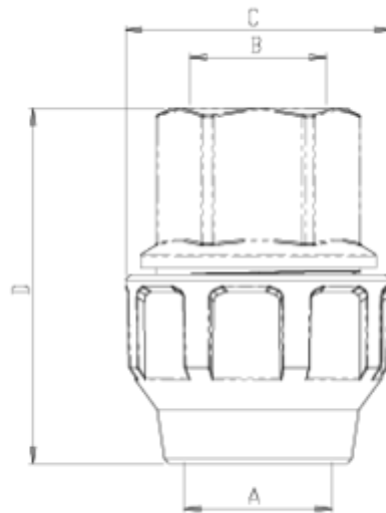

## ITEM 991 | Adaptor with brass female threaded insert

CÓDIGO	ØA	B	PESO (g)	C	D	PN	ROSCA
12682	32	1"	215	65	93	PN16	BSP
12683	40	1-1/4"	460	79	121	PN16	BSP
12684	50	1-1/2"	550	95	128	PN16	BSP
12685	63	2"	1030	117	156	PN16	BSP
12686	75	2-1/2"	1380	135	170	PN10	BSP
12687	90	3"	2350	160	204	PN10	BSP



## Product Documents



## Product Certificates



## Company Certificates

