



## Brass pressure fittings

# 90° coupling, male threaded ITEM 153

REFERENCE	DESCRIPTION	Net weight	Volumen (m <sup>3</sup> )	Gross weight	Unidades lote
1020091	90° BRASS ELBOW,M. THREAD 20-1/2"	0,1176	0,00892	7,245	60
1020092	90° BRASS ELBOW,M. THREAD 25-3/4"	0,184065	0,00892	7,55	40
1020093	90° BRASS ELBOW,M. THREAD 32-1"	0,296784	0,00892	7,607	25
1020094	90° BRASS ELBOW,M. THREAD 40-1 1/4"	0,488258	0,02244	18,065	36
1020095	90° BRASS ELBOW,M. THREAD 50-1 1/2"	0,745	0,02244	15,44	20
1020096	90° BRASS ELBOW,M. THREAD 63-2"	1,238	0,01553	15,096	12
1020097	90° BRASS ELBOW,M. THREAD 75-2 1/2"	1,831043	0,02244	13,305	7
1020098	90° BRASS ELBOW,M. THREAD 90-3"	2,436	0,02244	10,284	4



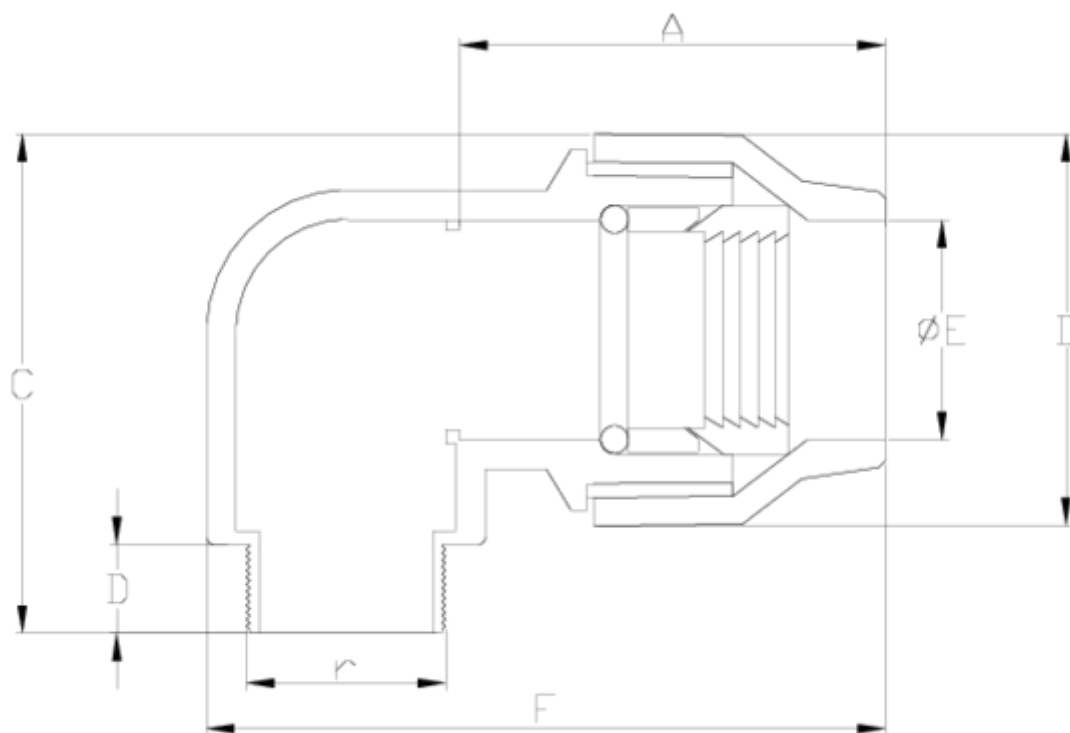

## ITEM 153 | 90° coupling, male threaded

Código	f tubo-R	Peso (g)	A	B	C	D	E	F	r	PN	TIPO ROSCA
20091	20-1/2"	125	31	35	42.5	9.2	21	55	1/2"	PN25	BSP
20092	25-3/4"	208	35	41.5	51.6	11	26	68	3/4"	PN25	BSP
20093	32-1"	272	42	49.5	63	14	33	75	1"	PN25	BSP
20094	40-1 1/4"	496	50	61	76	13.5	41.8	96	1 1/4"	PN25	BSP
20095	50-1 1/2"	745	52	74.3	95	14	51.2	108	1 1/2"	PN25	BSP
20096	63-2"	1238	63	91.2	108	15	64	135	2"	PN25	BSP
20097	75-2 1/2"	1735	135	95	110.8					PN25	BSP
20098	90-3"	2515	154	107	133.4					PN25	BSP



## Product Documents



## Product Certificates

## Company Certificates

