



"Ball" Check valve

Check valve "Ball" solvent socket outlet ITEM 635



| REFERENCE | DESCRIPTION | Net weight | Volumen (m ³) | Gross weight | Unidades lote |
|-----------|-------------------------------|------------|---------------------------|--------------|---------------|
| 1022003 | BALL CHECK V. SOLV. SOCKET 32 | 0,358665 | 0,02244 | 7,661 | 20 |
| 1022004 | BALL CHECK V. SOLV. SOCKET 40 | 0,507 | 0,03129 | 8,178 | 15 |
| 1022005 | BALL CHECK V. SOLV. SOCKET 50 | 0,90572 | 0,04717 | 14,2276 | 15 |
| 1022006 | BALL CHECK V. SOLV. SOCKET 63 | 1,501825 | 0,02244 | 6,495 | 4 |
| 1022007 | BALL CHECK V. SOLV. SOCKET 75 | 2,2942 | 0,03129 | 9,805 | 4 |
| 1022008 | BALL CHECK V. SOLV. SOCKET 90 | 3,8147 | 0,03129 | 8,23 | 2 |

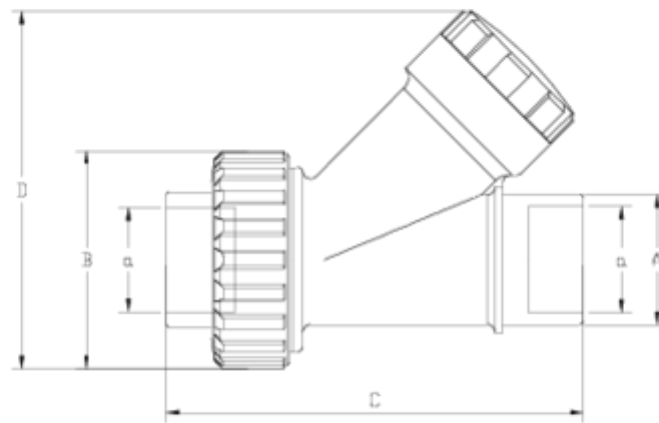

ITEM 635 | Check valve "Ball" solvent socket outlet

| CÓDIGO | a | Peso (g) | DN | A | B | C | D | PN | MEDIDA |
|--------|----|----------|----|-----|-----|-----|-----|------|---------|
| 22003 | 32 | 335 | 25 | 40 | 72 | 140 | 127 | PN10 | MÉTRICO |
| 22004 | 40 | 525 | 32 | 50 | 88 | 161 | 145 | PN10 | MÉTRICO |
| 22005 | 50 | 840 | 40 | 63 | 103 | 181 | 170 | PN10 | MÉTRICO |
| 22006 | 63 | 1450 | 50 | 75 | 120 | 218 | 220 | PN10 | MÉTRICO |
| 22007 | 75 | 2380 | 65 | 90 | 150 | 261 | 255 | PN10 | MÉTRICO |
| 22008 | 90 | 3835 | 80 | 110 | 181 | 325 | 280 | PN10 | MÉTRICO |



Product Documents



Product Certificates



Company Certificates

