



'Compact' ball valves

Male-Female threaded outlet

ITEM 569

REFERENCE	DESCRIPTION	Net weight	Volumen (m ³)	Gross weight	Unidades lote
111C030	GFPP COMP.B.VALV. FEM- MALE O. 1/2"	0,1064	0,00892	2,365	20
111C031	GFPP COMP.B.VALV. FEM- MALE O. 3/4"	0,13663	0,00892	2,97	20
111C032	GFPP COMP.B.V.1" FEM- MALE O.	0,20072	0,01553	3,375	15
111C033	GFPP COMP.B.V.1 1/4" FEM- MALE O.	0,323	0,02244	5,34	15
111C034	GFPP COMP.B.V.1 1/2" FEM- MALE O.	0,4502	0,02243	5,075	10
111C035	GFPP COMP.B.V.2" FEM- MALE O.	0,7414	0,02243	4,28	5



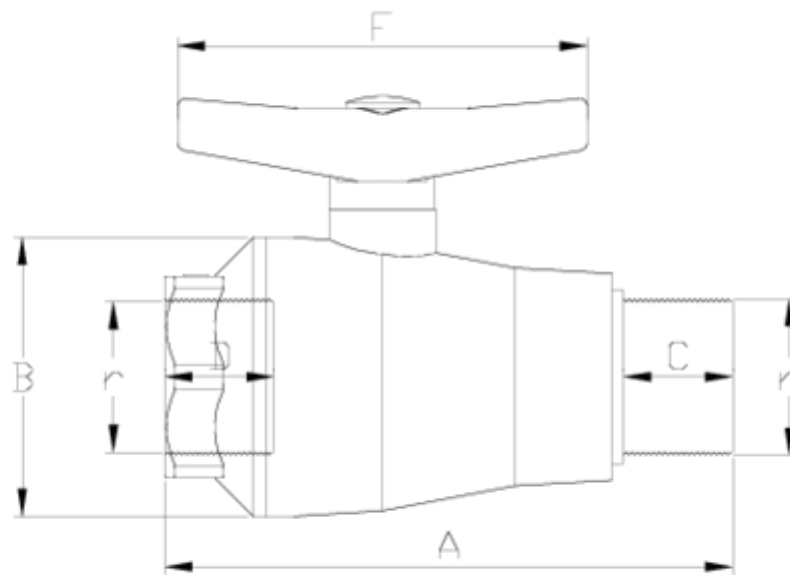

ITEM 569 | Male-Female threaded outlet

CÓDIGO	d-r	DN	PESO (g)	A	B	C	D	F	PN	TIPO ROSCA
11C040	20-1/2"	15	122	166	48	65	17	80	PN10	BSP
11C041	25-3/4"	20	149.38	178	53	65	20	80	PN10	BSP
11C042	32-1"	25	249	197	60	73	23	101	PN10	BSP
11C043	40-1 1/4"	32	381	222	74	81	26	130	PN10	BSP
11C044	50-1 1/2"	40	567	240	87	80	33	130	PN10	BSP
11C045	63-2"	50	1016	276	104	89	39	150	PN10	BSP



Product Documents



Product Certificates

Company Certificates

