



'Basic' ball valves

Cuerpo V.E bloque seguridad a/elec. 220v. - PTFE ITEM 261



REFERENCE	DESCRIPTION	Net weight	Volumen (m ³)	Gross weight	Unidades lote
1011569	BALL V. W/220v ELEC ACT,BAT BACK UP, 20	1,683	0,01553	1,923	1
1011570	BALL V. W/220v ELEC ACT,BAT BACK UP, 25	1,701	0,02244	2,241	1
1011571	BALL V. W/220v ELEC ACT,BAT BACK UP, 32	1,759	0,03129	2,299	1
1011572	BALL V. W/220v ELEC ACT,BAT BACK UP, 40	1,924	0,03129	2,484	1
1011573	BALL V. W/220v ELEC ACT,BAT BACK UP, 50	2,022	0,03129	2,582	1
1011574	BALL V. W/220v ELEC ACT,BAT BACK UP, 63	2,7	0,03648	3,4	1
1011575	BALL V. W/220v ELEC ACT,BAT BACK UP, 75	3,791	0,04460	4,631	1
1011576	BALL V. W/220v ELEC ACT,BAT BACK UP, 90	4,359	0,04460	5,199	1
1011577	BALL V. W/220v ELEC ACT,BAT BACK UP, 110	5,93	0,04460	6,77	1
1011578	BALL V. W/220v ELEC ACT,BAT BACK UP, 125	6,485	0,04460	7,325	1

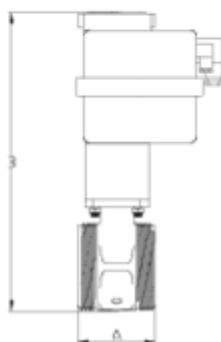

ITEM 261 | Cuerpo V.E bloque seguridad a/elec. 220v. - PTFE

CÓDIGO	f tubo	PESO (g)	DN	Actuador	A	B	C	PN	MEDIDA
11569	20	1683	15	S20	47	227	177	PN16	MÉTRICO
11570	25	1701	20	S20	51	232	177	PN16	MÉTRICO
11571	32	1759	25	S20	66	243	177	PN16	MÉTRICO
11572	40	1924	32	S20	72	265	177	PN16	MÉTRICO
11573	50	2022	40	S20	77	282	177	PN16	MÉTRICO
11574	63	2700	50	S20	90	352	177	PN16	MÉTRICO
11575	75	3791	65	S35	121	426	177	PN10	MÉTRICO
11576	90	4359	80	S55	141	453	177	PN10	MÉTRICO
11577	110	5930	100	S55	155	477	177	PN10	MÉTRICO
11578	125	6485	113	S85	161	500	177	PN10	MÉTRICO



ITEM 261 | Cuerpo V.E bloque seguridad a/elec. 220v. - PTFE



Product Documents



Product Certificates



Company Certificates

