



'Compact' ball valves

Female threaded npt - fpm seal

ITEM 986

REFERENCE	DESCRIPTION	Net weight	Volumen (m ³)	Gross weight	Unidades lote
111C374		0,459	0,01553	6,25	52.10
111C375		0,8255	0,01553	4,454	5



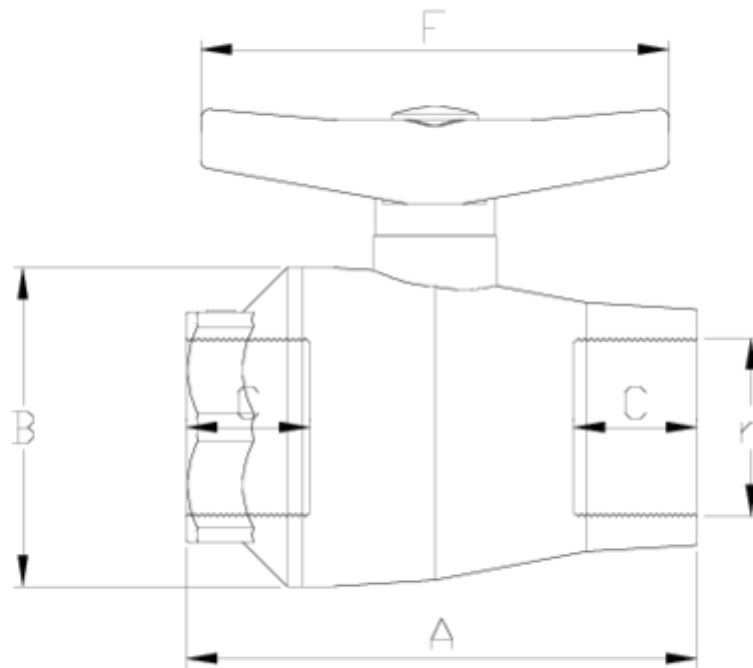

ITEM 986 | Female threaded npt - fpm seal

CÓDIGO	r	DN	PESO (g)	A	B	C	F	PN	TIPO ROSCA
11C374	1 1/2"	40	571.2	141	83	33	130	PN10	NPT
11C375	2"	50	912.8	162	104	39	172	PN10	NPT



Product Documents



Product Certificates

Company Certificates

