



'Basic' ball valves

Fittings/fittings outlet - PE - Basic System ITEM 214

REFERENCE	DESCRIPTION	Net weight	Volumen (m ³)	Gross weight	Unidades lote
1011110	BALL VALVE, FITTING OUTLET 20-20"	0,2571	0,03129	10,858	40
1011111	BALL VALVE, FITTING OUTLET 25-25"	0,338	0,03682	14,07	40
1011112	BALL VALVE, FITTING OUTLET 32-32"	0,525107	0,06149	16,6737	30
1011113	BALL VALVE, FITTING OUTLET 40-40"	0,977	0,04836	16,3	16
1011114	BALL VALVE, FITTING OUTLET 50-50"	1,308	0,06347	20,2	15
1011115	BALL VALVE, FITTING OUTLET 63-63"	2,09249	0,06347	21,59	10
1011116	BALL VALVE, FITTING OUTLET 75-75"	3,691225	0,04836	15,43	4
1011117	BALL VALVE, FITTING OUTLET 90-90"	6,7955	0,04460	14,325	2
1011118	BALL VALVE, FITTING OUTLET 110-110"	9,5651	0,04460	10,295	1



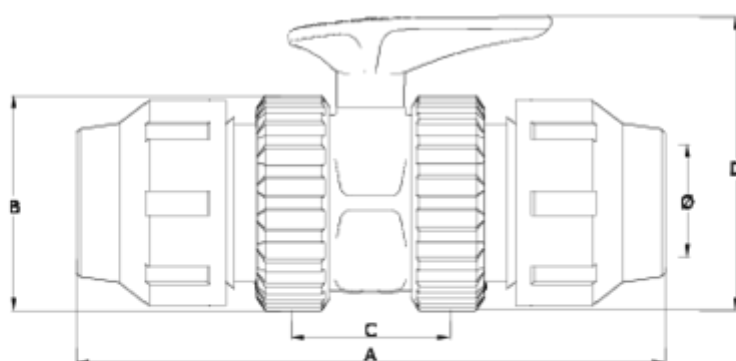

ITEM 214 | Fittings/fittings outlet - PE - Basic System

CÓDIGO	f	PESO (g)	DN	A	B	C	D	PN	MEDIDA
11110	20	224	15	203	52	47	78	PN16	MÉTRICO
11111	25	338	20	207	59	51	84	PN16	MÉTRICO
11112	32	525	25	246	70	66	97	PN16	MÉTRICO
11113	40	977	32	272	84	72	128	PN16	MÉTRICO
11114	50	1308	40	307	99	77	142	PN16	MÉTRICO
11115	63	2092	50	378	121	90	165	PN16	MÉTRICO
11116	75	3691	65	441	151	121	222	PN10	MÉTRICO
11117	90	6795	80	521	175	141	244	PN10	MÉTRICO
11118	110	9565	100	625	210	155	307	PN10	MÉTRICO



Product Documents



Product Certificates

Company Certificates

