



## GRPP hinged sleeve

# Hinged clamp saddle body reinforced

## ITEM 632



REFERENCE	DESCRIPTION	Net weight	Volumen (m <sup>3</sup> )	Gross weight	Unidades lote
1005172	REINFORC. HINGED SLEEVE BODY 160 PE OUTLET	2,652	0,03648	6,004	2
1005173	REINFORC. HINGED SLEEVE BODY 200 PE OUTLET	2,76505	0,04460	6,26	2
1005174	REINFORC. HINGED SLEEVE BODY 225 PE OUTLET	3,01	0,04836	6,86	2
1005175	REINFORC. HINGED SLEEVE BODY 250 PE OUTLET	3,50745	0,04836	7,68	2
1005176	REINFORC. HINGED SLEEVE BODY 315 PE OUTLET	5,8817	0,04880	6,451	1
1005177	REINFORC. HINGED SLEEVE BODY 400 PE OUTLET	6,4031	0,06347	7,19	1
1005178	REINFORCED HINGED SLEEVE BODY 400 (140-160 O.)	6,149	0,06347	6,94	1
1005186	REINFORCED HINGED SLEEVE BODY 315 (140-160 O.)	5,8947	0,04880	6,47	1



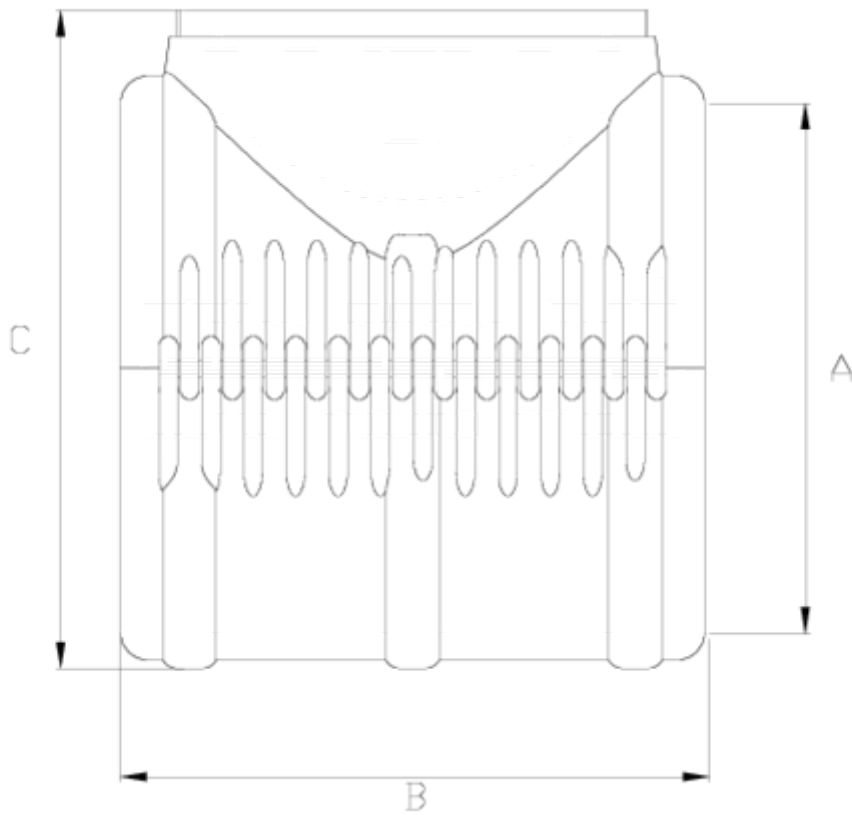

## ITEM 632 | Hinged clamp saddle body reinforced

CÓDIGO	f tubo	PESOS	A	B	C	PN	MEDIDA
05172	160	2742	160	225	216	PN6	MÉTRICO
05173	200	2800	200	227	250	PN6	MÉTRICO
05174	225	3083	225	225	274	PN6	MÉTRICO
05175	250	3454	250	239	299	PN6	MÉTRICO
05176	315	4706	315	250	361	PN6	MÉTRICO
05186	315	5300	315	282	390	PN6	MÉTRICO
05177	400	6427	400	282	456	PN6	MÉTRICO
05178	400	6600	400	282	450	PN6	MÉTRICO



## Product Documents



## Product Certificates

## Company Certificates

