



## Filters

# Net line filter

## ITEM 322

REFERENCE	DESCRIPTION	Net weight	Volumen (m <sup>3</sup> )	Gross weight	Unidades lote
1008131	NET LINE FILTER 3/4" 120 MESH	0,39	0,00891	1,7474	4
1008132	NET LINE FILTER 1" 120 MESH	0,30315	0,00891	1,4	4
1008133	NET LINE FILTER 1 1/4" 120 MESH	0,718	0,02243	2,732	4
1008134	NET LINE FILTER 1 1/2" 120 MESH	0,7	0,02243	3,2877	4
1008135	NET LINE FILTER 2" 120 MESH	0,835	0,01553	1,9967	2
1008136	NET LINE FILTER "S" 1 1/2" 120 MESH	0,897	0,01553	2,13	2



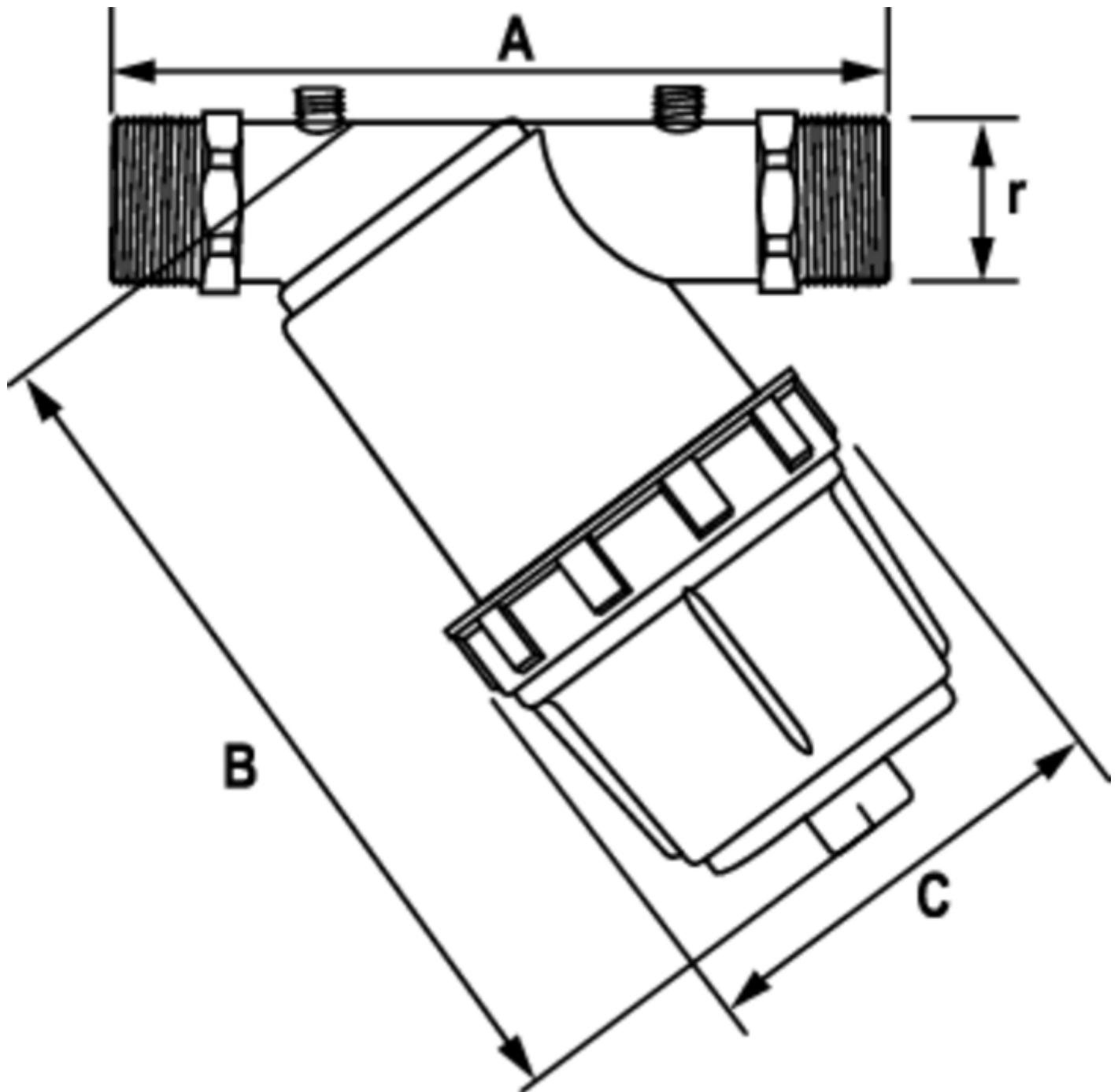



CÓDIGO	r	PESO (g)	MESH	máximo (L/h)	A	B	C	PN	TIPO ROSCA
08131	3/4"	315	120	5000	166	195	84	PN8	BSP
08132	1"	317	120	6000	166	195	84	PN8	BSP
08133	1 1/4"	697	120	10000	252	270	120	PN8	BSP
08134	1 1/2"	705	120	14000	252	270	120	PN8	BSP
08136	1 1/2" SUPER	890	120	20000	252	302	142	PN8	BSP
08135	2"	995	120	25000	267	315	140	PN8	BSP



Pol. Ind. Plá Vallonga,  
c/ Agua, 28  
03006 ALICANTE (España)



+34 965 11 42 82



+34 965 11 48 62



tecnicocomercial@hidroten.es



Technical &  
Commercial Service  
+ 34 966 105 888



www.hidroten.es



## Product Documents



## Product Certificates

## Company Certificates

