



## Netvic System® butterfly valves

# Netviyc System valve, plain threaded outlet, "AIR" elbow connection

## ITEM 683



REFERENCE	DESCRIPTION	Net weight	Volumen (m <sup>3</sup> )	Gross weight	Unidades lote
109N132	"AIR" NET. SYS. VAL. ELBOW PLAIN/THREADED 90-3/4"	3,93	0,04460	8,69	2
109N133	"AIR" NET. SYS. VAL. ELBOW PLAIN/THREADED 110-1"	5,06	0,04460	10,95	2
109N135	"AIR" NET. SYS. VAL. ELBOW PLAIN/THREADED 125-2"	6,255	0,04460	13,34	2
109N140	"AIR" NET. SYS. VAL. ELBOW PLAIN/THREADED 160-2"	10,344	0,06150	21,668	1
109N142	"AIR" NET. SYS. VAL. ELBOW PLAIN/THREADED 200-2"	13,825	0,04836	14,805	1

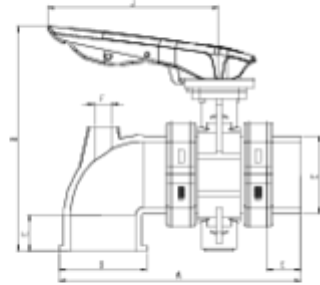

## ITEM 683 | Netviyc System valve, plain threaded outlet, "AIR" elbow connection

CÓDIGO	f	BRIDA	PESO	A	B	C	D	E	F	J	PN	MEDIDA
9N132	90	90	3930	288	334	164	121	51	3/4"	230	PN10	MÉTRICO
9N133	110	110	5060	308	376	188	144	61	1"	230	PN10	MÉTRICO
9N135	125	125	6255	344	411	203	159	69	2"	270	PN10	MÉTRICO
9N140	160	160	10344	386	498	251	201	86	2"	270	PN10	MÉTRICO
9N142	200	200	13825	460	601	297	251	106	2"	270	PN6	MÉTRICO



## Product Documents



## Product Certificates

## Company Certificates

