



PVC-U pressure fittings

Plain 90° tee

ITEM 009

| REFERENCE | DESCRIPTION | Net weight | Volumen (m ³) | Gross weight | Unidades lote |
|-----------|-----------------|------------|---------------------------|--------------|---------------|
| 1001025 | PVC 90° TEE 25 | 0,04422 | 0,01553 | 4,752 | 100 |
| 1001026 | PVC 90° TEE 32 | 0,07239 | 0,02244 | 5,555 | 70 |
| 1001027 | PVC 90° TEE 40 | 0,11601 | 0,03682 | 9,83 | 80 |
| 1001028 | PVC 90° TEE 50 | 0,195357 | 0,06149 | 13,6187 | 65 |
| 1001029 | PVC 90° TEE 63 | 0,333792 | 0,06347 | 13,471 | 38 |
| 1001030 | PVC 90° TEE 75 | 0,557385 | 0,04717 | 11,833 | 20 |
| 1001031 | PVC 90° TEE 90 | 0,9561 | 0,04717 | 12,115 | 12 |
| 1001032 | PVC 90° TEE 110 | 1,55045 | 0,06150 | 16,425 | 10 |
| 1001033 | PVC 90° TEE 125 | 2,02 | 0,06879 | 14,7337 | 7 |
| 1001034 | PVC 90° TEE 140 | 2,839925 | 0,04880 | 11,935 | 4 |
| 1001035 | PVC 90° TEE 160 | 3,787833 | 0,06649 | 12,284 | 3 |
| 1001036 | PVC 90° TEE 200 | 6,47 | 0,06347 | 13,77 | 2 |
| 1001075 | PVC 90° TEE 20 | 0,025646 | 0,00892 | 2,752 | 100 |
| 1001094 | PVC 90° TEE 225 | 8,85 | 0,06149 | 9,71 | 1 |
| 1001095 | PVC 90° TEE 250 | 11,882 | 0,06879 | 12,575 | 1 |
| 1001096 | PVC 90° TEE 315 | 22 | 0,16000 | 24,6 | 1 |
| 1001142 | PVC 90° TEE 16 | 0,014524 | 0,00892 | 2,366 | 150 |
| 1001147 | PVC 90° TEE 180 | 10,45905 | 0,06347 | 21,705 | 2 |
| 1001303 | PVC 90° TEE 400 | 41,74 | 0,24059 | 41,74 | 1 |



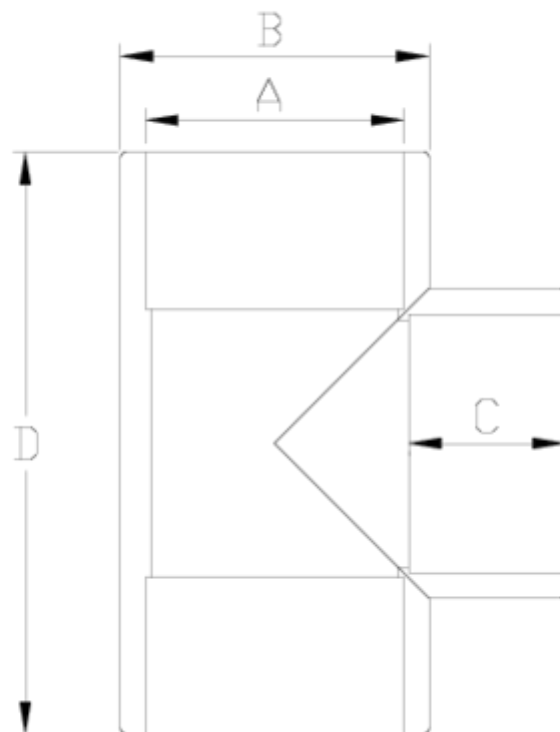

ITEM 009 | Plain 90° tee

| Código | A | Peso (g) | B | C | D | PN | MEDIDA |
|--------|-----|----------|-----|----|-----|------|---------|
| 01142 | 16 | 15 | 22 | 15 | 48 | PN16 | MÉTRICO |
| 01075 | 20 | 21 | 27 | 16 | 56 | PN16 | MÉTRICO |
| 01025 | 25 | 43 | 33 | 19 | 66 | PN16 | MÉTRICO |
| 01026 | 32 | 71 | 42 | 23 | 80 | PN16 | MÉTRICO |
| 01027 | 40 | 110 | 50 | 26 | 95 | PN16 | MÉTRICO |
| 01028 | 50 | 183 | 61 | 31 | 114 | PN16 | MÉTRICO |
| 01029 | 63 | 292 | 76 | 38 | 142 | PN16 | MÉTRICO |
| 01030 | 75 | 520 | 90 | 44 | 167 | PN16 | MÉTRICO |
| 01031 | 90 | 910 | 108 | 51 | 199 | PN16 | MÉTRICO |
| 01032 | 110 | 1465 | 131 | 61 | 238 | PN16 | MÉTRICO |



ITEM 009 | Plain 90° tee

| | | | | | | | |
|-------|-----|-------|-----|-----|-----|-------------|---------|
| 01033 | 125 | 1987 | 148 | 69 | 277 | PN16 | MÉTRICO |
| 01034 | 140 | 3170 | 164 | 76 | 305 | PN16 | MÉTRICO |
| 01035 | 160 | 3668 | 182 | 86 | 348 | PN10 | MÉTRICO |
| 01147 | 180 | 10200 | 225 | 106 | 408 | PN10 | MÉTRICO |
| 01036 | 200 | 6240 | 225 | 106 | 408 | PN10 | MÉTRICO |
| 01094 | 225 | 9600 | 252 | 119 | 470 | PN10 | MÉTRICO |
| 01095 | 250 | 12505 | 290 | 131 | 252 | PN10 | MÉTRICO |
| 01096 | 315 | 24588 | 352 | 164 | 514 | PN10 | MÉTRICO |
| 01303 | 400 | 39780 | 442 | 206 | 646 | PN6 | MÉTRICO |



Product Documents



Product Certificates

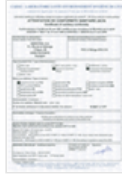

Company Certificates

