



## PP fittings for polyethylene

# "AIR" 90° elbow

### ITEM 543

REFERENCE	DESCRIPTION	Net weight	Volumen (m <sup>3</sup> )	Gross weight	Unidades lote
1012209	"AIR" 90° ELBOW EQUAL OUTLETS 63-3/4"	0,975	0,06347	15,525	15
1012210	"AIR" 90° ELBOW EQUAL OUTLETS 63-1"	0,979	0,06347	15,585	15
1012211	"AIR" 90° ELBOW EQUAL OUTLETS 25-1/2"	0,152	0,03129	8,19	50
1012212	"AIR" 90° ELBOW EQUAL OUTLETS 25-3/4"	0,14914	0,03129	8,03	50
1012213	"AIR" 90° ELBOW EQUAL OUTLETS 32-3/4"	0,250914	0,03648	9,375	35
1012214	"AIR" 90° ELBOW EQUAL OUTLETS 32-1"	0,238486	0,04460	9,11	35
1012215	"AIR" 90° ELBOW EQUAL OUTLETS 40-3/4"	0,388204	0,04460	10,435	25
1012216	"AIR" 90° ELBOW EQUAL OUTLETS 40-1"	0,352	0,04460	9,63	25
1012217	"AIR" 90° ELBOW EQUAL OUTLETS 50-3/4"	0,25	0,04460	4,58	15
1012218	"AIR" 90° ELBOW EQUAL OUTLETS 50-1"	0,25	0,04460	4,58	15



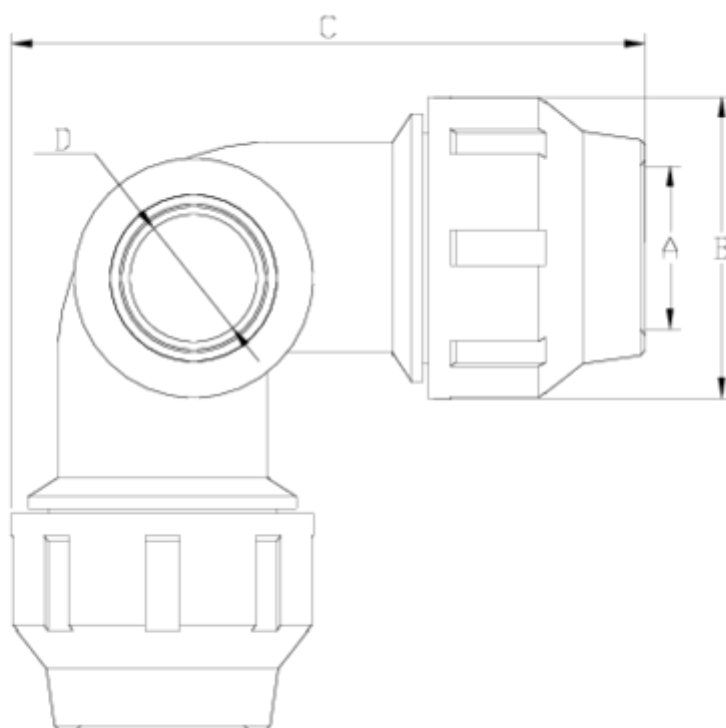

## ITEM 543 | "AIR" 90° elbow

Código	f tubo - D	Peso (g)	A	B	C	PN	ROSCA
12211	25 - 1/2"	147	26	55	115	PN16	BSP
12212	25 - 3/4"	152	26	55	115	PN16	BSP
12213	32 - 3/4"	216	33	64	132	PN16	BSP
12214	32 - 1"	222	33	64	132	PN16	BSP
12215	40 - 3/4"	347	42	76	155	PN16	BSP
12216	40 - 1"	352	42	76	155	PN16	BSP
12217	50 - 3/4"	550	51	91	173	PN16	BSP
12218	50 - 1"	556	51	91	173	PN16	BSP
12209	63 - 3/4"	955	64	109	205	PN16	BSP
12210	63 - 1"	945	64	109	205	PN16	BSP



## ITEM 543 | "AIR" 90° elbow

---



## Product Documents



## Product Certificates



## Company Certificates

