



## PP threaded fittings

# Manifold F/T

## ITEM 534

REFERENCE	DESCRIPTION	Net weight	Volumen (m <sup>3</sup> )	Gross weight	Unidades lote
1004236	PP PLAIN/F.THREAD MANIFOLD 63-2"	1,347925	0,02244	5,955	4
1004243	PP PLAIN/F.THREAD MANIFOLD 32-1"	0,4258	0,02243	4,748	10
1004245	PP PLAIN/F.THREAD MANIFOLD 63-1 1/2"	1,332925	0,02244	5,895	4



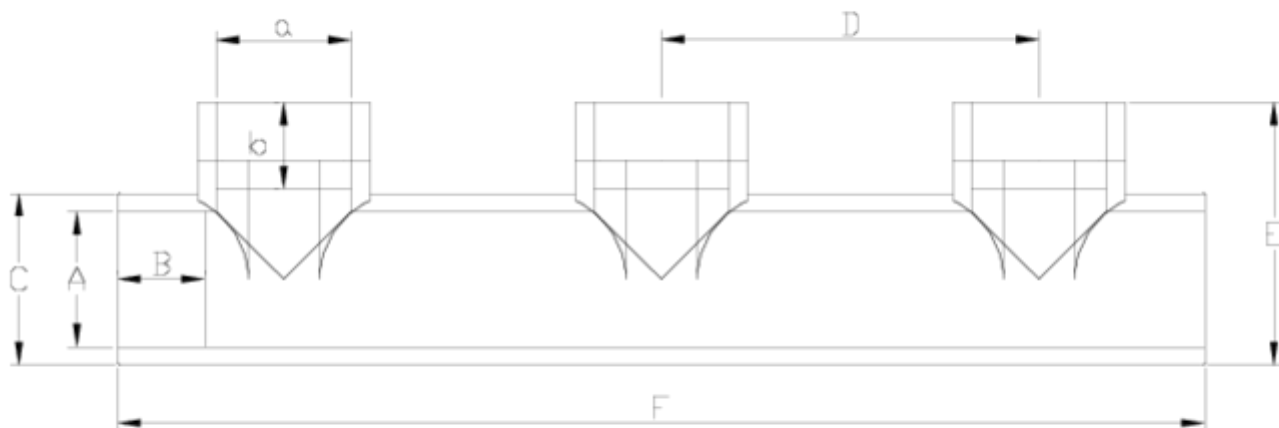

## ITEM 534 | Manifold F/T

Código	A-a	Peso (g)	b	B	C	D	E	F	PN	TIPO ROSCA
04242	1" -1"	240	22	22	40	115	61	308	PN10	BSP
04245	2"-1 1/2"	717	21	38	75	165	115	475	PN10	BSP
04236	2"-2"	781	26	38	75	165	115	475	PN10	BSP



## Product Documents



## Product Certificates



## Company Certificates

