



## PVC check valves (with spring)

# Plain/threaded outlet - FPM

## seal

### ITEM 270



REFERENCE	DESCRIPTION	Net weight	Volumen (m <sup>3</sup> )	Gross weight	Unidades lote
1016521	PVC CHECK V. (W/SPR), PLAIN-F.THR.1/2"-20 FPM	0,135	0,01553	5,64	40
1016522	PVC CHECK V. (W/SPR), PLAIN-F.THR.3/4"-25 FPM	0,177	0,01553	7,32	40
1016523	PVC CHECK V. (W/SPR), PLAIN-F.THR.1"-32 FPM	0,298143	0,02244	9,432	30
1016524	PVC CHECK V. (W/SPR), PLAIN-F.THR.1 1/4"-40 FPM	0,484	0,02244	10,22	20
1016525	PVC CHECK V. (W/SPR), PLAIN-F.THR.1 1/2"-50 FPM	0,7	0,03129	8,96	12
1016526	PVC CHECK V. (W/SPR), PLAIN-F.THR.2"-63 FPM	1,135	0,03129	11,91	10
1016527	PVC CHECK V. (W/SPR), PLAIN-F.THR.2 1/2"-75 FPM	2,207	0,03129	9,388	4
1016528	PVC CHECK V. (W/SPR), PLAIN-F.THR.3"-90 FPM	3,661	0,03129	7,882	2

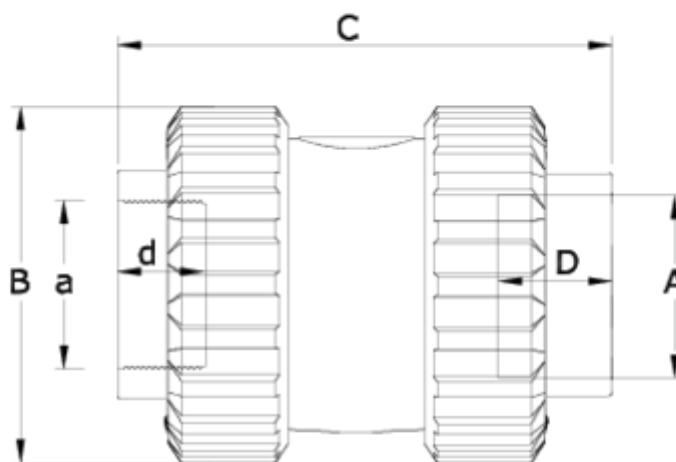

## ITEM 270 | Plain/threaded outlet - FPM seal

Código Vitón	A	a	Peso	B	C	D	d	PN	TIPO ROSCA
16521	20	1/2"	135	52	88	17	16	PN16	BSP
16522	25	3/4"	177	59	97	19	17	PN16	BSP
16522	32	1"	289	69	121	24	21	PN16	BSP
16522	40	1 1/4"	484	85	134	26	23	PN16	BSP
16522	50	1 1/2"	696	99	153	31	31	PN16	BSP
16522	63	2"	1111	116	169	38	38	PN16	BSP
16522	75	2 1/2"	2649	150	211	44	44	PN10	BSP
16522	90	3"	4258	178	246	51	52	PN10	BSP



## Product Documents



## Product Certificates

## Company Certificates

