



PVC-U pressure fittings

Reinforced F/T plain 90° tee

ITEM 436

REFERENCE	DESCRIPTION	Net weight	Volumen (m ³)	Gross weight	Unidades lote
1002180	PVC 90° TEE PLAIN/REINF F.THR./PLAIN 20-1/2"	0,031426	0,00892	3,33	100
1002181	PVC 90° TEE PLAIN/REINF F.THR./PLAIN 25-3/4"	0,050853	0,01553	5,412	100
1002182	PVC 90° TEE PLAIN/REINF F.THR./PLAIN 32-1"	0,0904	0,02244	6,817	70
1002183	PVC 90° TEE PLAIN/REINF F.THR./PLAIN 40-1 1/4"	0,165	0,03682	13,82	80
1002184	PVC 90° TEE PLAIN/REINF F.THR./PLAIN 50-1 1/2"	0,218	0,04717	14,93	65
1002185	PVC 90° TEE PLAIN/REINF F.THR./PLAIN 63-2"	0,3689	0,06347	14,849	38
1002186	PVC 90° TEE PLAIN/REINF F.THR./PLAIN 75-2 1/2"	0,575	0,04717	12,1205	20
1002187	PVC 90° TEE PLAIN/REINF F.THR./PLAIN 90-3"	1,05485	0,04717	13,3	12
1002188	PVC 90° TEE PLAIN/REINF F.THR./PLAIN 110-4"	1,6369	0,06149	17,29	10



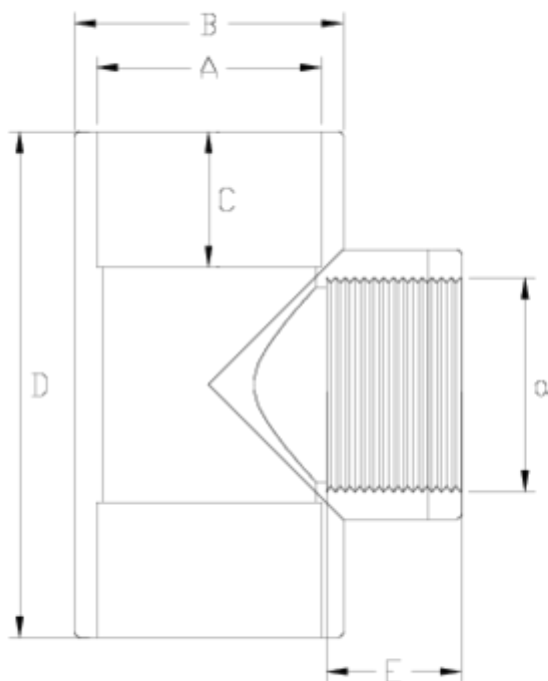

ITEM 436 | Reinforced F/T plain 90° tee

Código	A-a	Peso (g)	B	C	D	E	PN	ROSCA
02180	20-1/2"	34	27	16	56	16	PN10	BSP
02181	25-3/4"	56	33	19	66	17	PN11	BSP
02182	32-1"	96	41	22	79	21	PN12	BSP
02183	40-1 1/4"	165	50	26	95	23	PN13	BSP
02184	50-1 1/2"	218	61	31	114	24	PN14	BSP
02185	63-2"	352	75	38	141	28	PN15	BSP
02186	75-2 1/2"	575	90	45	166	32	PN16	BSP
02187	90-3"	1022	108	51	199	35	PN17	BSP
02188	110-4"	1562	131	61	238	39	PN18	BSP



Product Documents



Product Certificates

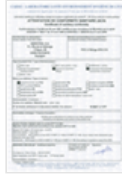

Company Certificates

