



## System check valves

# System check valve

## ITEM 285

REFERENCE	DESCRIPTION	Net weight	Volumen (m <sup>3</sup> )	Gross weight	Unidades lote
1013000	PP SYSTEM CHECK VALVE 63	0,47645	0,00472	1,07	2
1013001	PP SYSTEM CHECK VALVE 75	0,47895	0,00472	1,075	2
1013002	PP SYSTEM CHECK VALVE 90	0,6761	0,00473	0,805	1
1013003	PP SYSTEM CHECK VALVE 110	0,8611	0,00891	0,99	1
1013004	PP SYSTEM CHECK VALVE 125	1,1658	0,00892	1,365	1
1013005	PP SYSTEM CHECK VALVE 140	1,6488	0,00892	1,85	1
1013006	PP SYSTEM CHECK VALVE 160	2,1588	0,00983	2,434	1
1013007	PP SYSTEM CHECK VALVE 200/225	3,7744	0,01553	4,12	1
1013008	PP SYSTEM CHECK VALVE 250	6,8718	0,03648	7,76	1
1013009	PP SYSTEM CHECK VALVE 315	9,9245	0,06150	11,134	1
1013031	PP SYSTEM CHECK VALVE 400 SS 316	15,61	0,36961	19,36	1



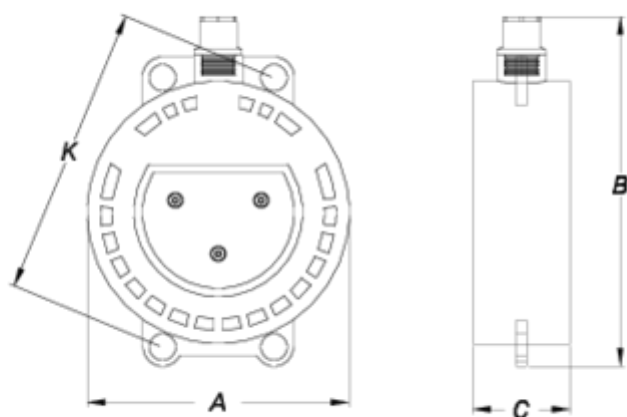

## ITEM 285 | System check valve

Código	Ø tubo	Peso (g)	DN	A	B	C	K	PN	MEDIDA
13000	63	455	65	136	187	54	125-145	PN16	MÉTRICO
13001	75	455	65	136	187	54	125-145	PN16	MÉTRICO
13002	90	665	80	130	221	58	146-160	PN16	MÉTRICO
13003	110	798	100	151	242	59	178-190	PN16	MÉTRICO
13004	125	1093	110	170	260	67	190	PN16	MÉTRICO
13005	140	1445	125	190	277	73	210-216	PN16	MÉTRICO
13006	160	2052	150	217	297	80	235-241	PN10	MÉTRICO
13007	200/225	2940	200	250	329	95	292-298	PN10	MÉTRICO
13008	250	6840	250	322	370	128	350-362	PN10	MÉTRICO
13009	315	10500	300	370	480	131	400-432	PN10	MÉTRICO



## ITEM 285 | System check valve

13031

400

13675

400

478

630

180

515-550

PN6

MÉTRICO



## Product Documents



## Product Certificates

## Company Certificates

