



## Accesorios roscados PP

# Colector 3 vías R/M

## ITEM 555

| REFERENCIA | DESCRIPCIÓN                      | Peso neto | Volumen (m <sup>3</sup> ) | Peso bruto | Unidades lote |
|------------|----------------------------------|-----------|---------------------------|------------|---------------|
| 1004316    | COLECTOR 3 VIAS R/M PP 2"-2"     | 1,244875  | 0,04460                   | 5,785      | 4             |
| 1004323    | COLECTOR 3 VIAS R/M PP 1"-1"     | 0,029     | 0,01553                   | 3,59       | 10            |
| 1004325    | COLECTOR 3 VIAS R/M PP 2"-1 1/2" | 1,262925  | 0,02244                   | 5,615      | 4             |



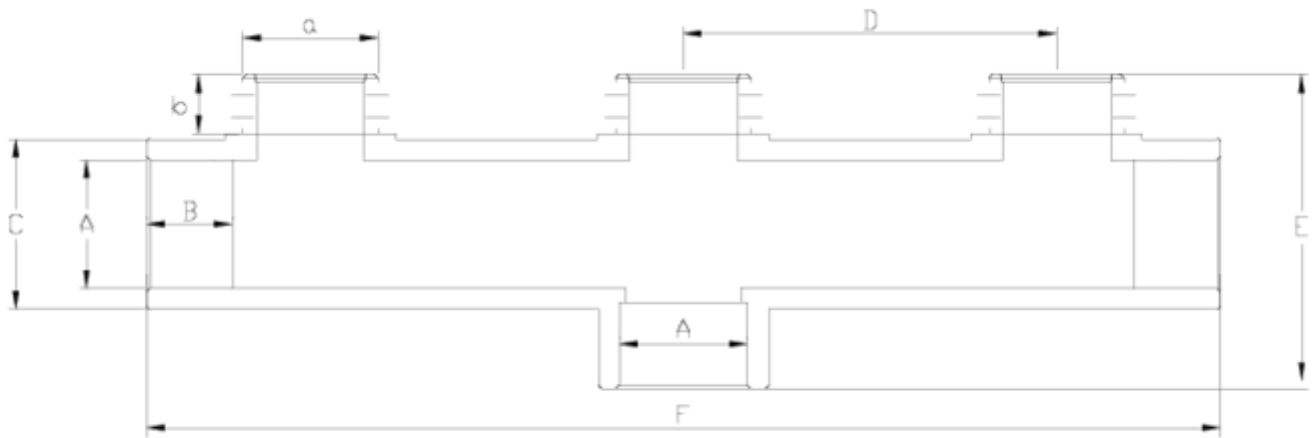

## ITEM 555 | Colector 3 vías R/M

| Código | A-a       | Peso (g) | b  | B  | C  | D   | E   | F   | PN   | TIPO ROSCA |
|--------|-----------|----------|----|----|----|-----|-----|-----|------|------------|
| 04322  | 1" -1"    | 275      | 19 | 22 | 40 | 115 | 85  | 308 | PN10 | BSP        |
| 04325  | 2"-1 1/2" | 710      | 21 | 38 | 75 | 165 | 97  | 475 | PN10 | BSP        |
| 04316  | 2"-2"     | 769      | 26 | 38 | 75 | 165 | 102 | 475 | PN10 | BSP        |



## Documentación de Producto



## Certificados de Producto



## Certificados de Empresa

